

5.2 OPTION B - Proposed Tenant Wall Signage @ Roof Screenwall
(For Rear Tenant Without Route 1 Exposure)



Proposed Qualifications:
Quantity = Maximum (1) Sign In This Location
Sign Area = Maximum 100sf.
Maximum Letter Height = 60"
Sign To Be Internally Illuminated

Sign Location: Must Be Located On Rooftop Screenwall & May Not Extend Above Top Edge Of Screenwall
Tenant Location: For Tenant Who Has No External Wall Or Visibility From Route One
* Proposed Screenwall To Be Added Only If Tenant Signage 5.2 Is Approved By Zoning/West Windsor Township.

Sign Location Plan (Route 1 Tenant Wall Signage)

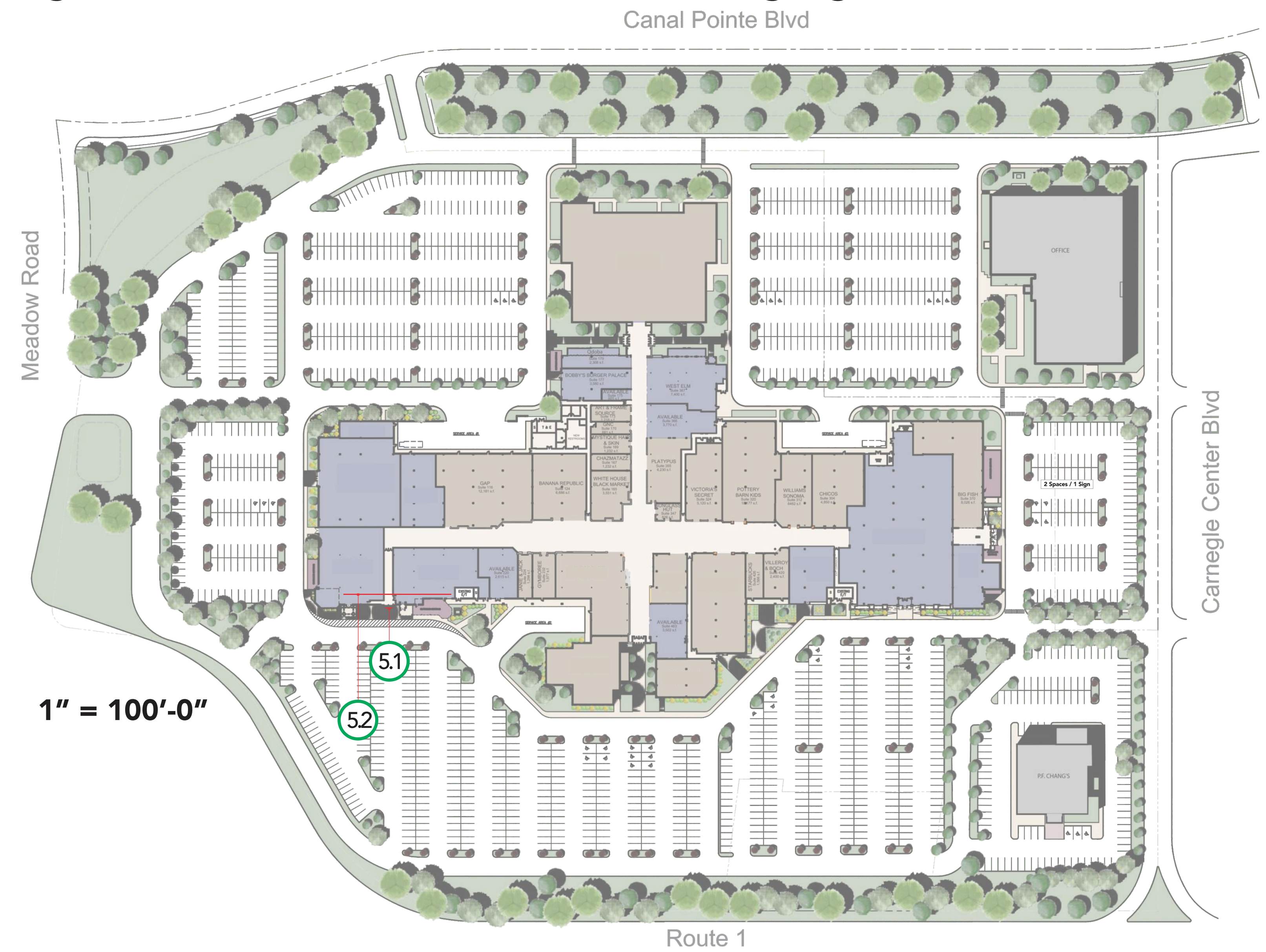

5.2 OPTION B - Implementation Studies Based On Proposed Criteria (Tenant Wall Signs)



Scale: 1/16" 1'-0"

5.1 OPTION A - Proposed Tenant Wall Signage @ Mall Entry
(For Rear Tenant Without Route 1 Exposure)



Proposed Qualifications:
Quantity = Maximum (1) Sign In This Location
Sign Area = Maximum 60sf.
Maximum Letter Height = 60"
Sign To Be Internally Illuminated



Sign Location: Must Be Located Within Sign Zone Noted In Rendering (Yellow Dashed Line)
Tenant Location: For Tenant Who Has No External Wall Or Visibility From Route One

All Designs/Sizes Subject To Review & Approval By Local Zoning